



Particularly large pumps, agitators, mixers, autoclaves, filters, calenders, fermenters and similar units with large shafts often have a tendency for the shafts to move very eccentrically. This applies both to axial, radial and pendulating movements. Conventional mechanical seals cannot cope with these extreme conditions. DEPAC offers the mechanical seal type 365 for such applications. Thanks to its unique design with "floating" seal faces, the mechanical seal is capable of absorbing these extreme movements in the seal itself and nevertheless always maintaining the faces in the same pressure ratio to each other. This mechanical seal operates reliably and fully independently of any shaft movements.

Advantages

- Free movement space of +/- 3.0 mm* axial, radial and pendulating
- Cartridge-mounted
- Double balanced and tandem-active
- Independent of the direction of rotation
- Venting option
- Multiple springs made of Hastelloy C
- Springs outside the medium - no blockage of the springs
- Vibration-dampend stationary face support

Mechanical seal

Type 365

Technical specifications

Area of application*

Pressure:	700 mm Hg to 28 bar
Temperature:	dependent on elastomer
Sliding speed:	up to 25 m/s
Shaft movements:	axial +/- 3.0 mm
	radial +/- 3.0 mm

* The maximum specifications for temperature, pressure and sliding speed apply in each case to independent higher operating conditions. However, this does not mean that the seal will function with all extreme conditions at the same time. If in doubt contact DEPAC.

Dimensions

Shaft diameter:	25 – 200 mm
	1" – 7 ¾"
	Special sizes on enquiry

Bill of materials

Item	Description	Material
1.1	Sleeve	1.4571
1.2	Gland	1.4571
1.4	Adjusting ring	1.4571
1.6	Circlip	1.4310
2.1, 2.4	Dynamic seal face	SC/SSIC/TC
2.2, 2.3	Stationary seal face	CA/SC/SSIC/TC
3.1, 3.2, 3.3, 3.4, 3.5, 3.6, 3.7, 3.8, 311	O-ring	FKM, EPDM, Kalrez®, PTFE,...
3.10	Flat gasket	Klingersil® C-4300
4.1	Centering piece	Al
4.3	Cheesehead screw	A2
4.6	Threaded pin	A4
4.7	Bleed screw	A2
5.1	Spring	2.4610

Other materials on enquiry!

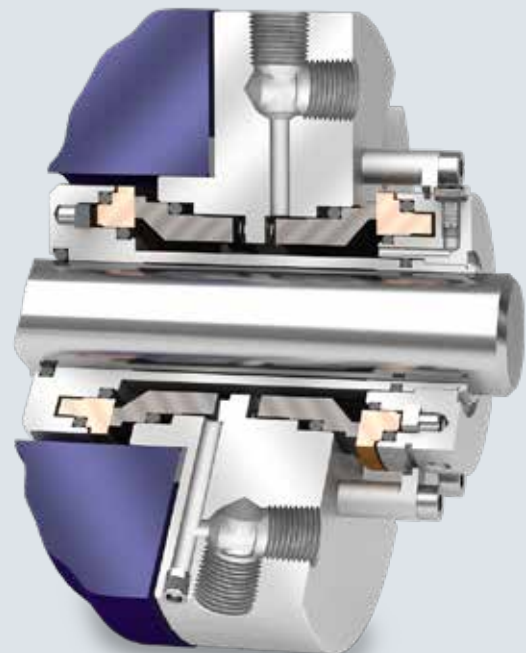

Mechanical seal Type 365 Data sheet

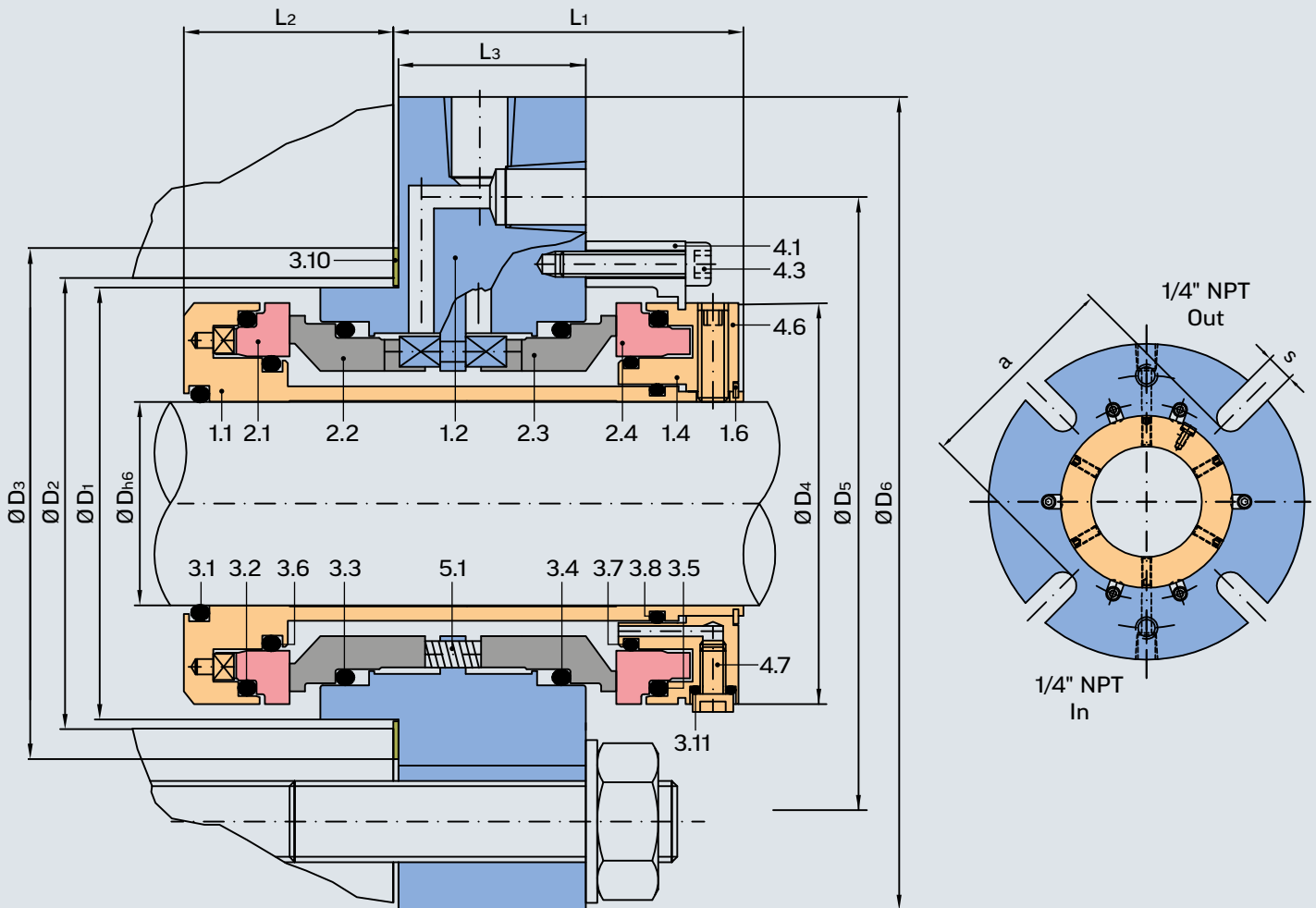

Dimension table Ø 25 – 50 millimetres

Dh6	D1	D2 min.	D2 max.	D3	D4	D5	D6	L1	L2	L3	a	s	O-rings DASH no.								
													3.1	3.2	3.3	3.4	3.5	3.6	3.7	3.8	3.11
25	70	70.5	80	88	64	115	155	68.5	42.5	36	88	14.7	214	227	226	226	227	221	128	121	009
28	73	73.5	83	91	67	115	155	68.5	42.5	36	91	14.7	216	228	226	226	228	222	130	123	009
30	75	75.5	85	93	69	120	160	68.5	42.5	36	93	14.7	217	228	227	227	228	223	131	124	009
32	77	77.5	87	95	71	120	160	68.5	42.5	36	95	14.7	219	229	228	228	229	223	132	125	009
33	78	78.5	88	96	72	120	160	68.5	42.5	36	96	14.7	219	229	228	228	229	224	133	126	009
35	80	80.5	90	98	74	125	165	68.5	42.5	36	98	14.7	221	230	229	229	230	224	134	127	009
38	83	83.5	93	101	77	125	165	68.5	42.5	36	101	14.7	222	231	230	230	231	225	136	129	009
40	85	85.5	95	103	79	130	170	68.5	42.5	36	103	14.7	223	232	230	230	232	226	137	130	009
43	88	88.5	98	106	82	130	170	68.5	42.5	36	106	14.7	224	233	231	231	233	227	139	132	009
45	90	90.5	100	108	84	135	175	68.5	42.5	36	108	14.7	225	233	232	232	233	228	140	133	009
48	93	93.5	103	111	87	135	175	68.5	42.5	36	111	14.7	226	234	233	233	234	229	142	135	009
50	95	95.5	105	113	89	140	180	68.5	42.5	36	113	17.5	226	235	233	233	235	229	144	137	009

Mechanical seal

Type 365

Data sheet

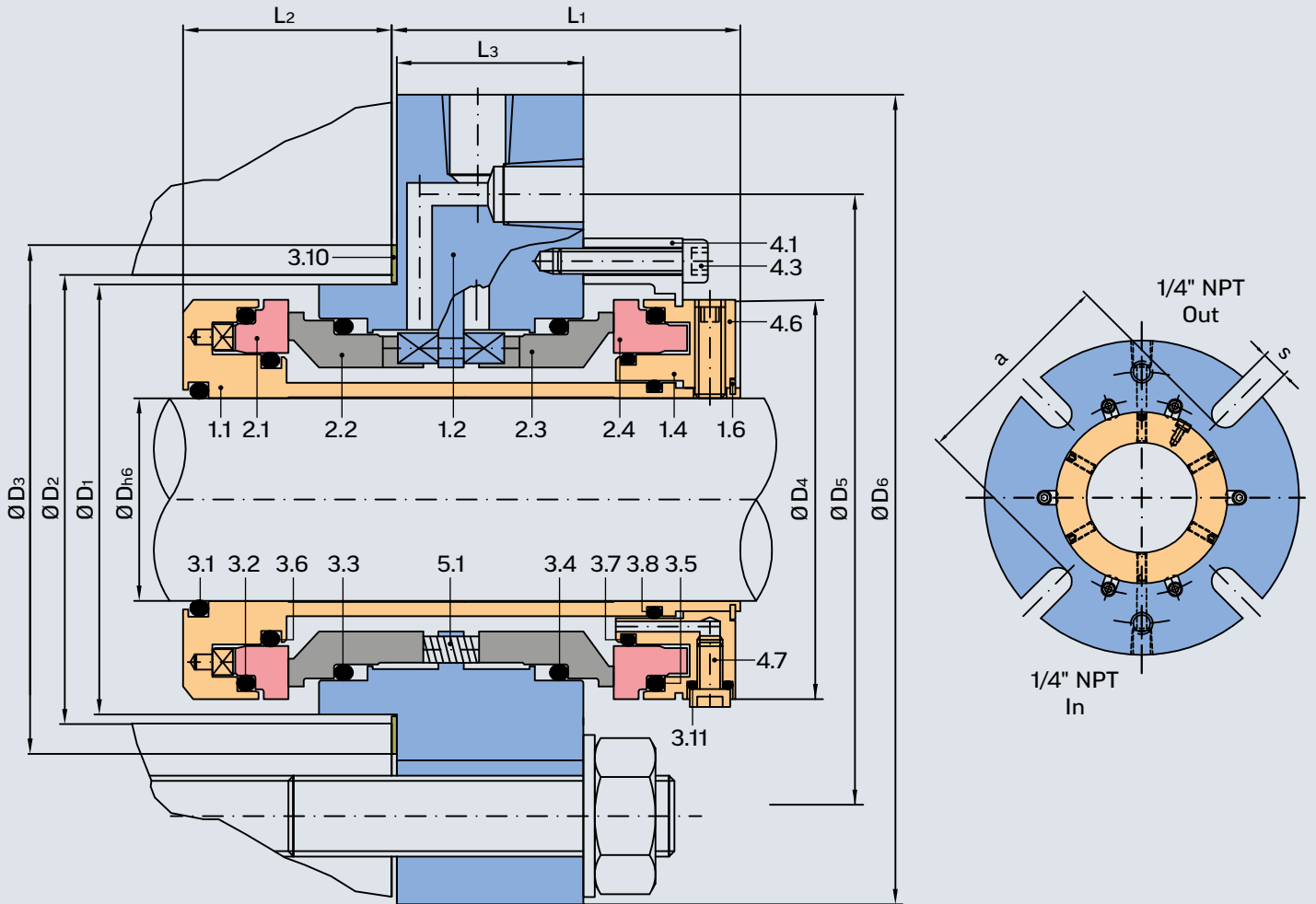

Dimension table Ø 55 – 110 millimetres

Dh6	D1	D2 min.	D2 max.	D3	D4	D5	D6	L1	L2	L3	a	s	O-rings DASH no.								
													3.1	3.2	3.3	3.4	3.5	3.6	3.7	3.8	3.11
55	100	100.5	110	118	94	145	185	68.5	42.5	36	118	17.5	228	236	235	235	236	231	147	140	009
60	105	105.5	115	123	99	150	190	68.5	42.5	36	123	17.5	229	238	237	237	238	232	150	143	009
65	110	110.5	120	128	104	155	195	68.5	42.5	36	128	17.5	231	240	238	238	240	234	151	146	009
70	115	115.5	125	133	109	160	200	68.5	42.5	36	133	17.5	232	241	240	240	241	235	152	149	009
75	120	120.5	130	138	114	165	205	68.5	42.5	36	138	17.5	234	243	241	241	243	237	153	151	009
80	125	125.5	135	143	119	170	210	68.5	42.5	36	143	17.5	236	244	243	243	244	239	153	152	009
85	130	130.5	140	148	124	175	215	68.5	42.5	36	148	21.5	237	246	244	244	246	240	154	152	009
90	135	135.5	145	153	129	180	220	68.5	42.5	36	153	21.5	239	247	246	246	247	242	155	153	009
95	140	140.5	150	158	134	185	225	68.5	42.5	36	158	21.5	240	249	248	248	249	243	156	154	009
100	145	145.5	155	163	139	190	230	68.5	42.5	36	163	21.5	242	251	249	249	251	245	157	155	009
105	150	150.5	160	168	144	195	235	68.5	42.5	36	168	21.5	244	252	251	251	252	246	157	156	009
110	155	155.5	165	173	149	200	240	68.5	42.5	36	173	21.5	245	254	252	252	254	248	158	156	009

Mechanical seal Type 365 Data sheet

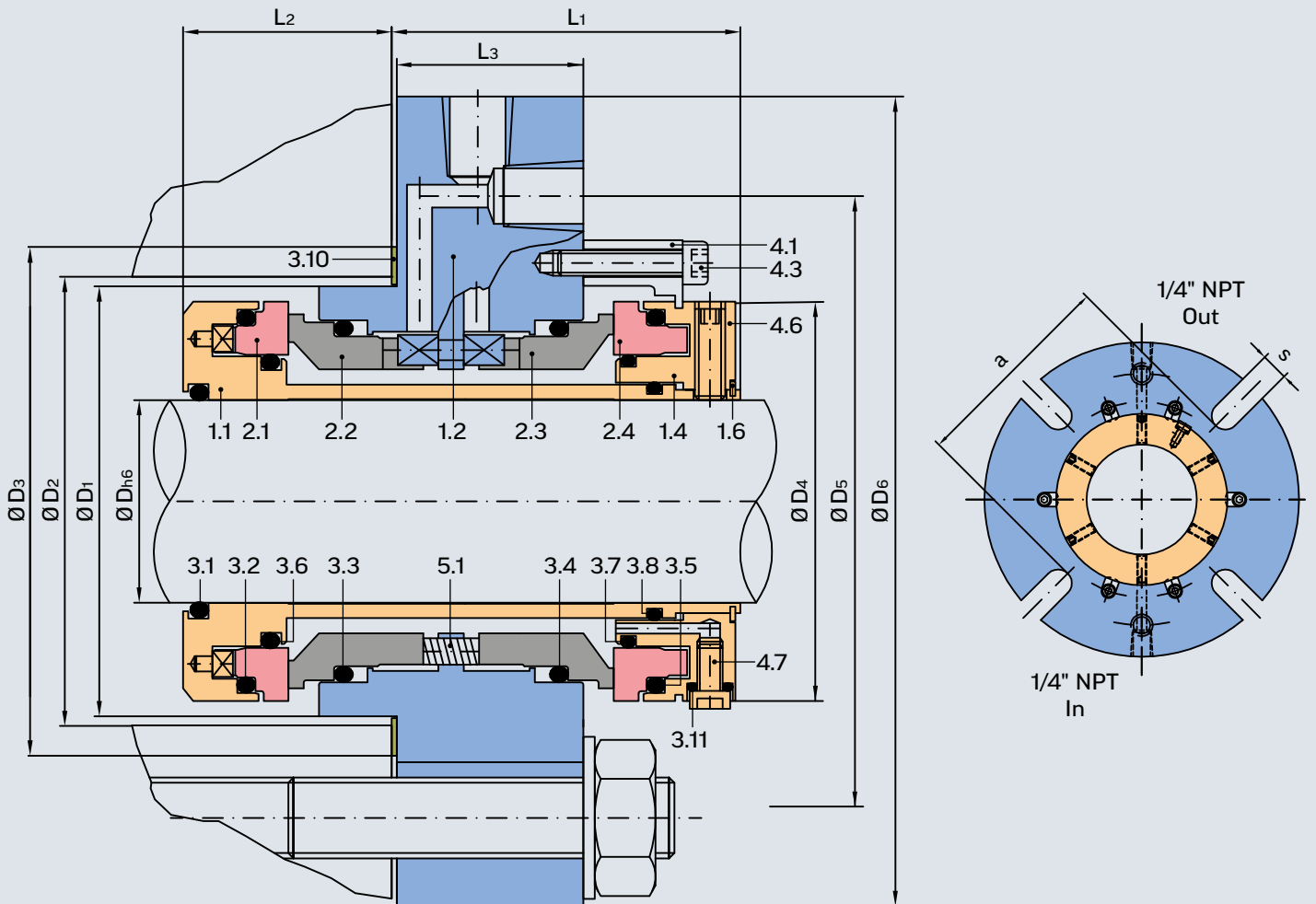

Dimension table Ø 115 – 170 millimetres

Dh6	D1	D2 min.	D2 max.	D3	D4	D5	D6	L1	L2	L3	a	s	O-rings DASH no.								
													3.1	3.2	3.3	3.4	3.5	3.6	3.7	3.8	3.11
115	160	160.5	170	178	154	205	245	68.5	42.5	36	178	21.5	247	255	254	254	255	250	159	157	009
120	165	165.5	175	183	159	210	250	68.5	42.5	36	183	21.5	248	257	255	255	257	251	160	158	009
125	170	170.5	180	188	164	215	255	68.5	42.5	36	188	21.5	250	258	257	257	258	253	160	159	009
130	175	175.5	185	193	169	220	260	68.5	42.5	36	193	21.5	251	259	258	258	259	254	161	159	009
135	180	180.5	190	198	174	225	265	68.5	42.5	36	198	21.5	253	260	259	259	260	256	162	160	009
140	185	185.5	195	203	179	230	270	68.5	42.5	36	203	21.5	255	260	260	260	260	258	163	161	009
145	190	190.5	200	208	184	235	275	68.5	42.5	36	208	21.5	256	261	260	260	261	258	164	162	009
150	195	195.5	205	213	189	240	280	68.5	42.5	36	213	21.5	258	262	261	261	262	259	164	163	009
155	200	200.5	210	218	194	245	285	68.5	42.5	36	218	21.5	259	263	262	262	263	260	165	163	009
160	205	205.5	215	223	199	250	290	68.5	42.5	36	223	21.5	260	263	263	263	263	261	166	164	009
165	210	210.5	220	228	204	255	295	68.5	42.5	36	228	21.5	260	264	264	264	264	261	167	165	009
170	215	215.5	225	233	209	260	300	68.5	42.5	36	233	21.5	261	265	264	264	265	262	168	166	009

Mechanical seal

Type 365

Data sheet

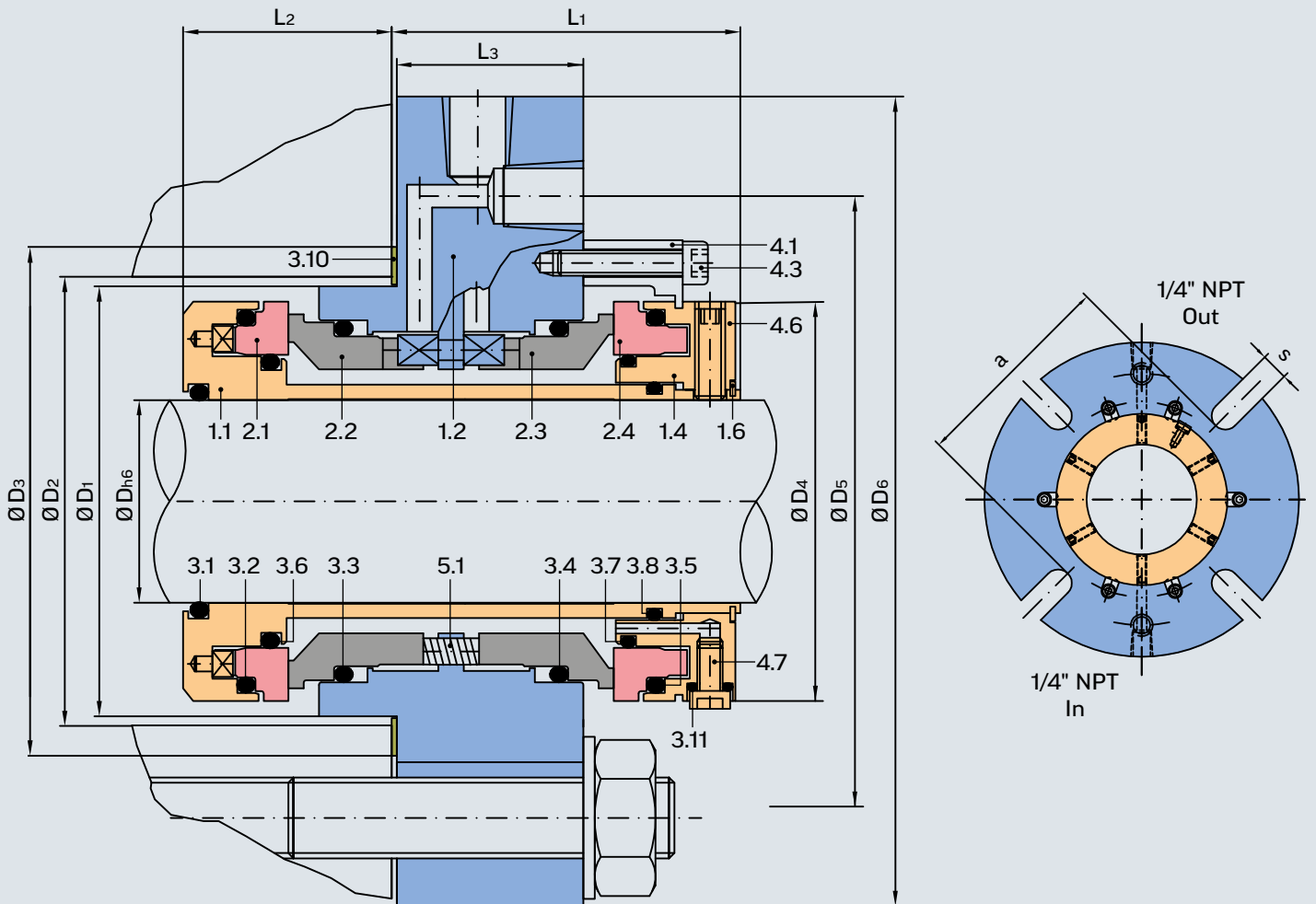

Dimension table Ø 175 - 200 millimetres

Dh6	D1	D2 min.	D2 max.	D3	D4	D5	D6	L1	L2	L3	a	s	O-rings DASH no.								
													3.1	3.2	3.3	3.4	3.5	3.6	3.7	3.8	3.11
175	220	220.5	230	238	214	265	305	68.5	42.5	36	238	21.5	262	266	265	265	266	263	168	167	009
180	225	225.5	235	243	219	270	310	68.5	42.5	36	243	21.5	263	267	266	266	267	264	169	167	009
185	230	230.5	240	248	224	275	315	68.5	42.5	36	248	21.5	264	267	267	267	267	265	170	168	009
190	235	235.5	245	253	229	280	320	68.5	42.5	36	253	21.5	264	268	268	268	268	265	171	169	009
195	240	240.5	250	258	234	285	325	68.5	42.5	36	258	21.5	265	269	268	268	269	266	171	170	009
200	245	245.5	255	263	239	290	330	68.5	42.5	36	263	21.5	266	270	269	269	270	267	172	171	009

Mechanical seal Type 365 Data sheet

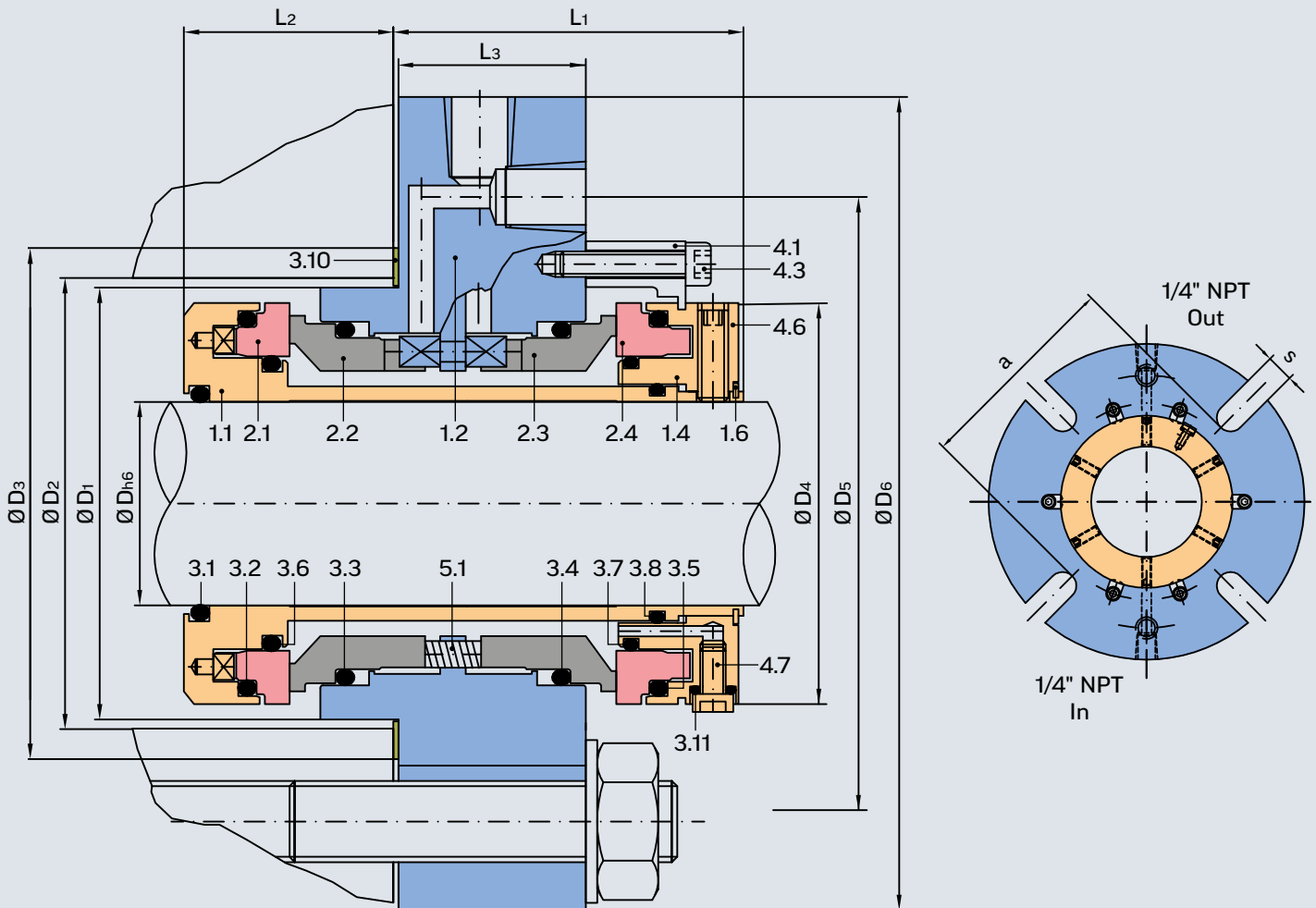

Dimension table $\varnothing 1 - 2 \frac{3}{8}$ inches

Dh6	D1	D2 min.	D2 max.	D3	D4	D5	D6	L1	L2	L3	a	s	O-rings DASH no.								
													3.1	3.2	3.3	3.4	3.5	3.6	3.7	3.8	3.11
1	2.756	2.776	3.150	3.465	2.612	4.694	6.102	2.697	1.735	1.469	3.465	0.579	214	227	226	226	227	221	128	121	009
1 1/8	2.874	2.894	3.268	3.583	2.735	4.694	6.102	2.697	1.735	1.469	3.583	0.579	216	228	226	226	228	222	130	123	009
1 1/4	3.031	3.051	3.425	3.740	2.898	4.898	6.299	2.697	1.735	1.469	3.740	0.579	219	229	228	228	229	223	132	125	009
1 3/8	3.150	3.170	3.543	3.858	3.020	5.102	6.496	2.697	1.735	1.469	3.858	0.579	221	230	229	229	230	224	134	127	009
1 1/2	3.268	3.288	3.661	3.976	3.143	5.102	6.496	2.697	1.735	1.469	3.976	0.579	222	231	230	230	231	225	136	129	009
1 5/8	3.425	3.445	3.819	4.134	3.306	5.306	6.693	2.697	1.735	1.469	4.134	0.579	223	232	231	231	232	227	139	132	009
1 3/4	3.543	3.563	3.937	4.252	3.429	5.510	6.890	2.697	1.735	1.469	4.252	0.579	225	233	232	232	233	228	140	133	009
1 7/8	3.661	3.681	4.055	4.370	3.551	5.510	6.890	2.697	1.735	1.469	4.370	0.579	226	234	233	233	234	229	142	135	009
2	3.937	3.957	4.331	4.646	3.837	5.918	7.283	2.697	1.735	1.469	4.646	0.689	228	236	235	235	236	231	147	140	009
2 1/8	3.937	3.957	4.331	4.646	3.837	5.918	7.283	2.697	1.735	1.469	4.646	0.689	228	236	235	235	236	231	147	140	009
2 1/4	4.134	4.154	4.528	4.843	4.041	6.122	7.480	2.697	1.735	1.469	4.843	0.689	229	238	237	237	238	232	150	143	009
2 3/8	4.134	4.154	4.528	4.843	4.041	6.122	7.480	2.697	1.735	1.469	4.843	0.689	229	238	237	237	238	232	150	143	009

Mechanical seal

Type 365

Data sheet

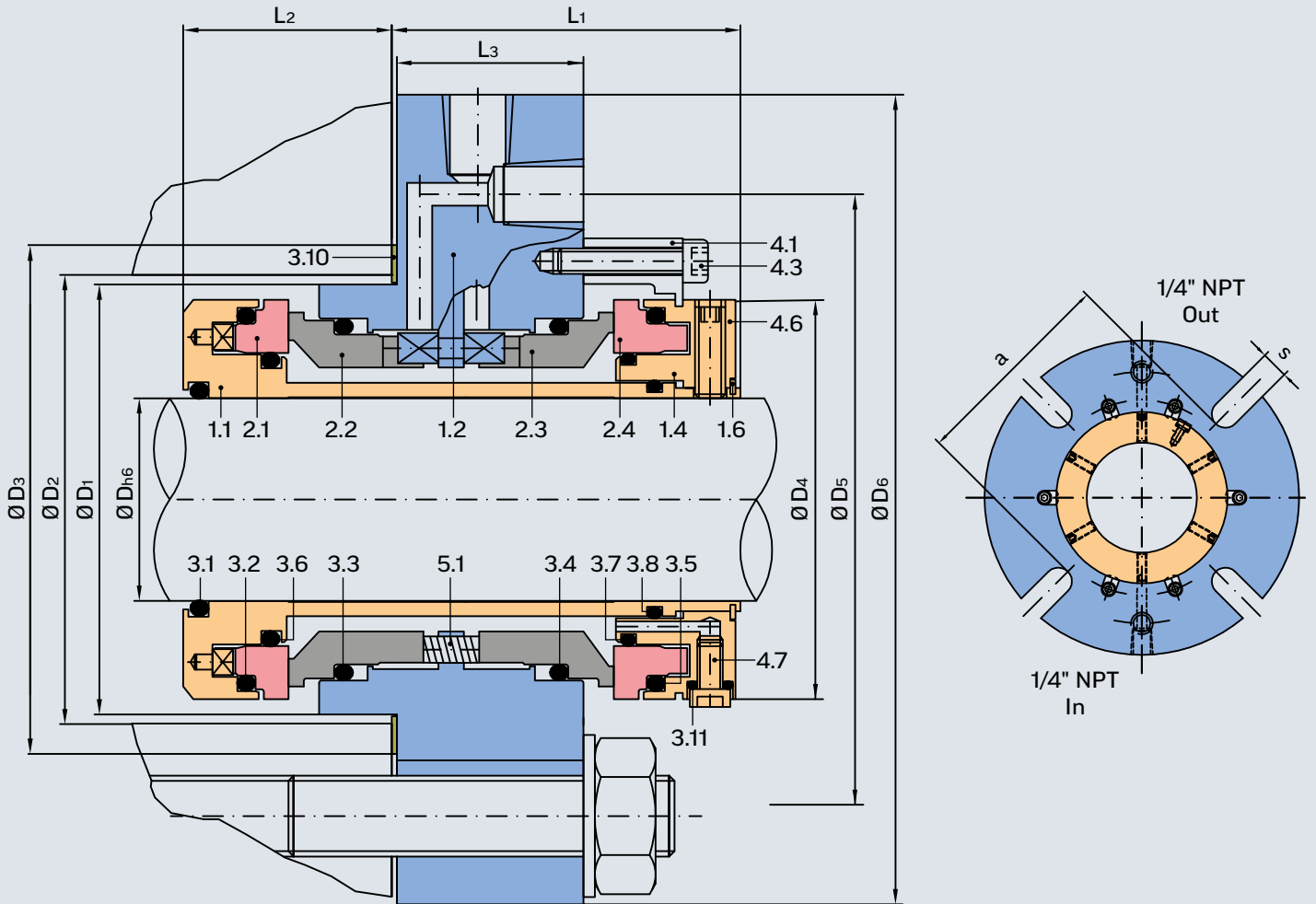

Dimension table $\varnothing 2 \frac{1}{2} - 4$ inches

Dh6	D1	D2 min.	D2 max.	D3	D4	D5	D6	L1	L2	L3	a	s	O-rings DASH no.								
													3.1	3.2	3.3	3.4	3.5	3.6	3.7	3.8	3.11
2 ½	4.331	4.351	4.898	5.039	4.245	6.327	7.677	2.697	1.735	1.469	5.039	0.689	231	240	238	238	240	234	151	146	009
2 ½	4.528	4.548	5.102	5.236	4.449	6.531	7.874	2.697	1.735	1.469	5.236	0.689	232	241	240	240	241	235	152	149	009
2 ¾	4.528	4.548	5.102	5.236	4.449	6.531	7.874	2.697	1.735	1.469	5.236	0.689	232	241	240	240	241	235	152	149	009
2 ¾	4.724	4.744	5.306	5.433	4.653	6.735	8.071	2.697	1.735	1.469	5.433	0.689	234	243	241	241	243	237	153	151	009
3	4.921	4.941	5.510	5.630	4.857	6.939	8.268	2.697	1.735	1.469	5.630	0.689	234	244	243	243	244	239	153	152	009
3 ⅓	4.921	4.941	5.510	5.630	4.857	6.939	8.268	2.697	1.735	1.469	5.630	0.689	236	244	243	243	244	239	153	152	009
3 ½	5.118	5.138	5.714	5.827	5.061	7.143	8.465	2.697	1.735	1.469	5.827	0.846	237	246	244	244	246	240	154	152	009
3 ½	5.315	5.335	5.918	6.024	5.265	7.347	8.661	2.697	1.735	1.469	6.024	0.846	239	247	246	246	247	242	155	153	009
3 ½	5.315	5.335	5.918	6.024	5.265	7.347	8.661	2.697	1.735	1.469	6.024	0.846	239	247	246	246	247	242	155	153	009
3 ¾	5.512	5.532	6.122	6.220	5.469	7.551	8.858	2.697	1.735	1.469	6.220	0.846	240	249	248	248	249	243	156	154	009
3 ¾	5.512	5.532	6.122	6.220	5.469	7.551	8.858	2.697	1.735	1.469	6.220	0.846	240	249	248	248	249	243	156	154	009
4	5.906	5.926	6.531	6.614	5.878	7.959	9.252	2.697	1.735	1.469	6.614	0.846	244	252	251	251	252	246	157	156	009

Mechanical seal Type 365 Data sheet

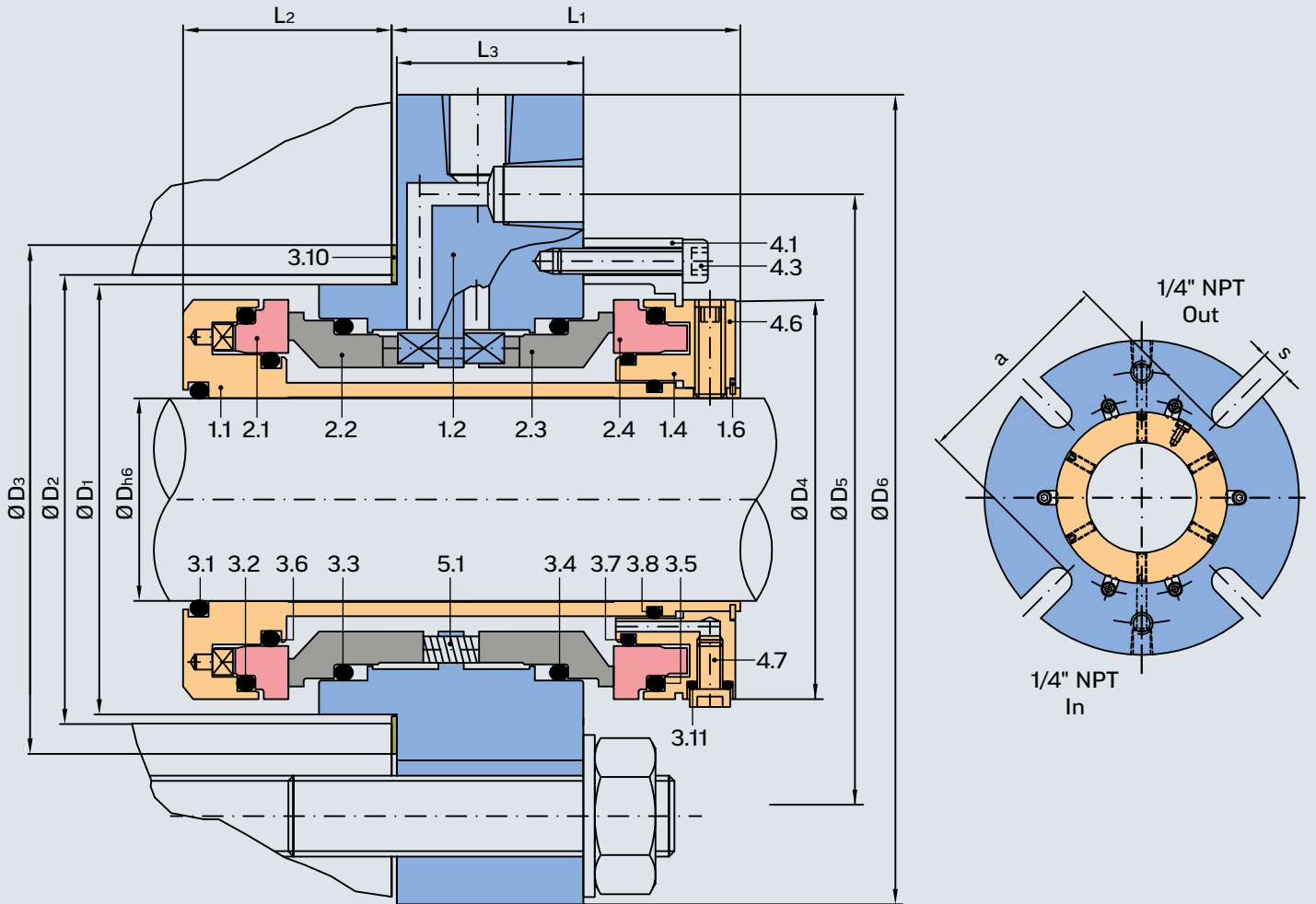

Dimension table $\varnothing 4 \frac{1}{8} - 6 \frac{1}{2}$ inches

Dh6	D1	D2 min.	D2 max.	D3	D4	D5	D6	L1	L2	L3	a	s	O-rings DASH no.								
													3.1	3.2	3.3	3.4	3.5	3.6	3.7	3.8	3.11
4 1/8	5.906	5.926	6.531	6.614	5.878	7.959	9.252	2.697	1.735	1.469	6.614	0.846	244	252	251	251	252	246	157	156	009
4 1/4	6.102	6.122	6.735	6.811	6.082	8.163	9.449	2.697	1.735	1.469	6.811	0.846	245	254	252	252	254	248	158	156	009
4 1/2	6.299	6.319	6.939	7.008	6.286	8.367	9.646	2.697	1.735	1.469	7.008	0.846	247	255	254	254	255	250	159	157	009
4 3/4	6.693	6.713	7.347	7.402	6.694	8.776	10.039	2.697	1.735	1.469	7.402	0.846	250	258	257	257	258	253	160	159	009
5	6.890	6.910	7.551	7.598	6.898	8.980	10.236	2.697	1.735	1.469	7.598	0.846	251	259	258	258	259	254	161	159	009
5 1/8	6.890	6.910	7.551	7.598	6.898	8.980	10.236	2.697	1.735	1.469	7.598	0.846	251	259	258	258	259	254	161	159	009
5 1/4	7.087	7.107	7.755	7.795	7.102	9.184	10.433	2.697	1.735	1.469	7.795	0.846	253	260	259	259	260	256	162	160	009
5 1/2	7.283	7.303	7.959	7.992	7.306	9.388	10.630	2.697	1.735	1.469	7.992	0.846	255	260	260	260	260	258	163	161	009
5 3/4	7.677	7.697	8.367	8.386	7.714	9.796	11.024	2.697	1.735	1.469	8.386	0.846	258	262	261	261	262	259	164	163	009
6	7.874	7.894	8.571	8.583	7.918	10.000	11.220	2.697	1.735	1.469	8.583	0.846	259	263	262	262	263	260	165	163	009
6 1/4	8.071	8.091	8.776	8.780	8.122	10.204	11.417	2.697	1.735	1.469	8.780	0.846	260	263	263	263	263	261	166	164	009
6 1/2	8.268	8.288	8.980	8.976	8.327	10.408	11.614	2.697	1.735	1.469	8.976	0.846	260	264	264	264	264	261	167	165	009

Mechanical seal

Type 365

Data sheet

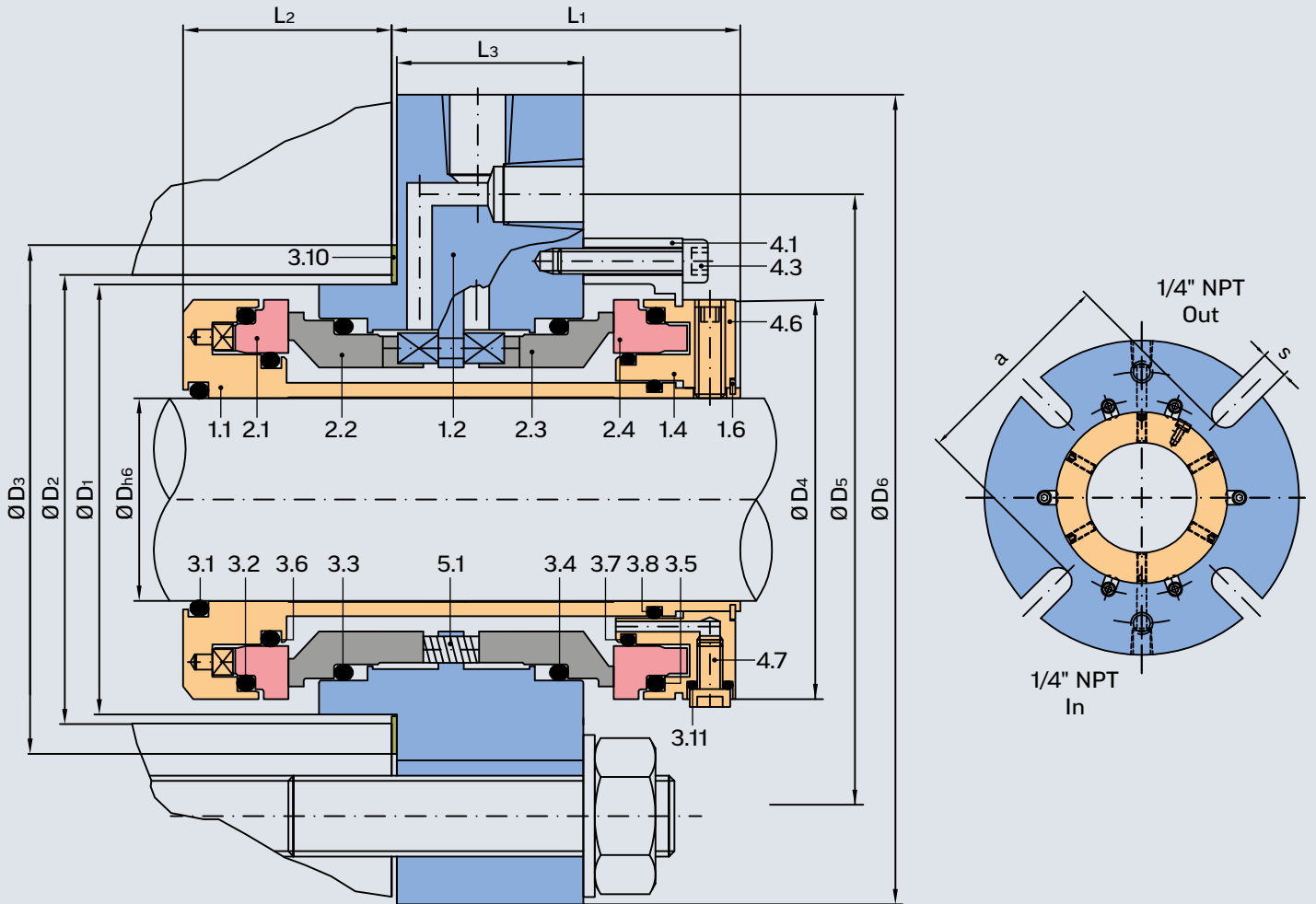

Dimension table Ø 6 ¾ - 7 ¾ inches

Dh6	D1	D2 min.	D2 max.	D3	D4	D5	D6	L1	L2	L3	a	s	O-rings DASH no.									
													3.1	3.2	3.3	3.4	3.5	3.6	3.7	3.8	3.11	
6 ¾	8.661	8.681	9.388	9.370	8.735	10.816	12.008	2.697	1.735	1.469	9.370	0.846	262	266	265	265	266	263	168	167	009	
7	8.858	8.878	9.592	9.567	8.939	11.020	12.205	2.697	1.735	1.469	9.567	0.846	263	267	266	266	267	264	169	167	009	
7 ¼	9.055	9.075	9.796	9.764	9.143	11.224	12.402	2.697	1.735	1.469	9.764	0.846	264	267	267	267	267	265	170	168	009	
7 ½	9.449	9.469	10.204	10.157	9.551	11.633	12.795	2.697	1.735	1.469	10.157	0.846	265	269	268	268	269	266	171	170	009	
7 ¾	9.646	9.666	10.408	10.354	9.755	11.837	12.992	2.697	1.735	1.469	10.354	0.846	266	270	269	269	270	267	172	171	009	